

# Jinan Meide - Fig 121

## Malleable Iron 45 Degree Street Elbows (Male/Female)

### General Specifications

Available Black (Self-Colour) & HDG Galvanised  
 Cast Malleable Iron Fittings (Dimensions to BS EN 10242)  
 BSPT Taper/Taper Threaded (ISO 7-1)  
 BSI Kitemarked  
 Maximum Pressure: 25 bar  
 Temperature Range: -20°C - 300°C  
 ISO 9001 Accredited Manufacturer

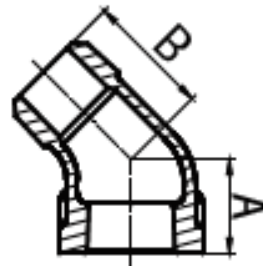

Nominal bore		Length centre to face dim. A	Length centre to face dim. B	Weight each
Metric	Imperial	mm	mm	kgs
6mm	1/8	16	21	0.03
8mm	1/4	18.5	24	0.04
10mm	3/8	20	25	0.07
15mm	1/2	22	28	0.10
20mm	3/4	25	32	0.15
25mm	1	28	37	0.25
32mm	1 1/4	33	43	0.37
40mm	1 1/2	50	46	0.48
50mm	2	58	55	0.79
65mm	2 1/2	69	65	1.43
80mm	3	78	76	2.13
100mm	4	96	94	3.84