

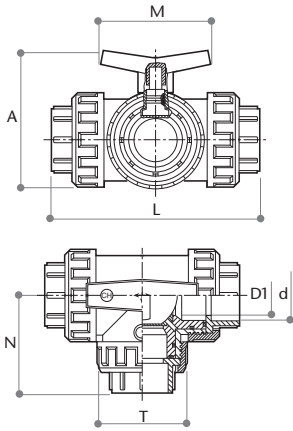

## BVT13

3 way ball valves 'T' port with double union ends for solvent welding EPDM seals



d	D1	L	A	M	T	N	Kg. PVC
3/8"	15	112	80	85	45	57	0.226
1/2"	15	112	80	85	45	57	0.221
3/4"	20	123	87	85	55	62	0.300
1"	25	147	104	100	66	74	0.489
1 1/4"	32	169	115	100	79	82	0.742
1 1/2"	40	209	145	127	102	104	1.436
2"	50	230	160	127	111	117	2.142