

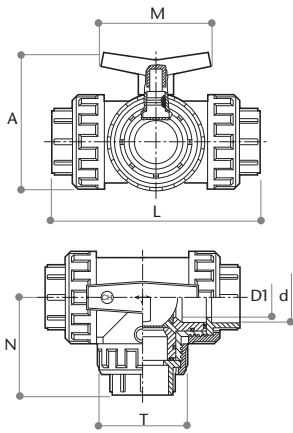

## BVL11

3 way ball valves 'L' port with double union BSP ends EPDM seals



| d      | D1 | L   | A   | M   | T   | N   | Kg. PVC |
|--------|----|-----|-----|-----|-----|-----|---------|
| 3/8"   | 15 | 112 | 80  | 85  | 45  | 57  | 0.229   |
| 1/2"   | 15 | 112 | 80  | 85  | 45  | 57  | 0.220   |
| 3/4"   | 20 | 123 | 87  | 85  | 55  | 62  | 0.303   |
| 1"     | 25 | 147 | 104 | 100 | 66  | 74  | 0.488   |
| 1 1/4" | 32 | 169 | 115 | 100 | 79  | 82  | 0.746   |
| 1 1/2" | 40 | 209 | 145 | 127 | 102 | 104 | 1.475   |
| 2"     | 50 | 230 | 160 | 127 | 111 | 117 | 1.885   |