

BVD10 – Double union ball valve with plain solvent welding ends

U-PVC double union ball valve with female ends for solvent welding EN ISO 1452. Round ball with surface worked by grinding machine. EPDM seals with double O-R stem, PTFE ball seats. Working pressure PN16 from D.16 up to D.63, PN10 from D.75 up to D.110

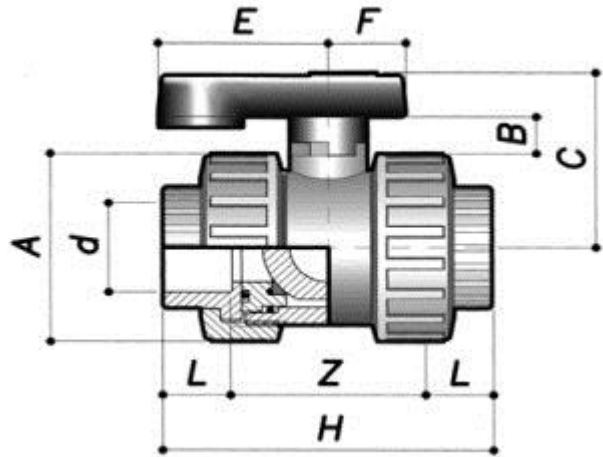

Dimensions

Code	d	DN	L	Z	H	A	B	C	E	F	PN	Gr	Pack	Box
BVD10016	16	10	14	53	81	50	10	48	39	19	16	140	60	S
BVD10020	20	15	16	49	81	50	10	48	39	19	16	130	60	S
BVD10025	25	20	19	56	94	60	11	54	47	22	16	210	36	S
BVD10032	32	25	22	63	107	68	13	62	55	25	16	310	50	M
BVD10040	40	32	26	72	124	80	18	75	60	30	16	450	30	M
BVD10050	50	40	31	84	146	96	20	87	68	35	16	700	20	M
BVD10063	63	50	38	94	170	116	20	101	80	40	16	1180	12	M
BVD10075	75	65	44	130	218	145	25	123	90	45	10	2230	5	M
BVD10090	90	80	51	148	250	166	28	138	100	50	10	3520	3	M
BVD10110	110	100	61	168	290	210	28	160	120	60	10	5830	2	M

Components

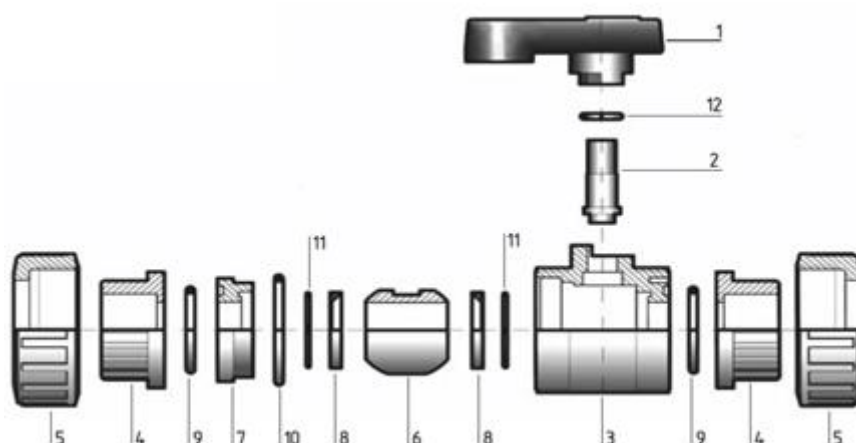

Pos.	Components	N°	Material
1	handle	1	PVC
2	stem	1	PVC
3	body	1	PVC
4	union end	2	PVC
5	union nut	2	PVC
6	ball	1	PVC
7	sealing bush	1	PVC
8	ball seat	2	PTFE
9	union O-ring	2	EPDM
10	O-ring sealing bush	1	EPDM
11	O-ring ball seat	2	EPDM
12	O-ring stem	2	EPDM