

# Viking Grooved Reducing Tees



## Approvals



Nominal size		Pipe OD	Approvals				Weight approx.
DN	inch	mm (Inch)	VdS	LPCB	FM	UL	kg (lbs)
50x40	2x1-1/2	60.3 x 48.3 (2.38 x 1.90)	C	E	F	F	0.79 (1.75)
65x40	3 ODx1-1/2	76.1x48.3 (3.00x1.90)	C	E	F	F	1.33 (2.94)
65x50	2-1/2x2	73.0x60.3 (2.88x2.38)	-	-	F	F	1.21 (2.68)
	3 ODx2	76.1x60.3 (3.00x2.38)	C	E	F	F	1.36 (2.99)
80x50	3x2	88.9x60.3 (3.50x2.38)	C	E	F	F	1.68 (3.70)
80x65	3x2-1/2	88.9x73.0 (3.50x2.88)	-	-	F	F	1.78 (3.92)
	3x3 OD	88.9x76.1 (3.50x3.00)	C	E	F	D	1.85 (4.07)
100x50	4x2	114.3x60.3 (4.50x2.38)	C	E	F	F	2.68 (5.92)
100x65	4x2-1/2	114.3x73.0 (4.50x2.88)	-	-	F	F	2.78 (6.13)
	4x3 OD	114.3x76.1 (4.50x3.00)	C	E	F	D	2.85 (6.29)
100x80	4x3	114.3x88.9 (4.50x3.50)	C	E	F	F	2.86 (6.30)
125x50	5x2	141.3x60.3 (5.56x2.38)	-	-	F	F	6.44 (14.2)
125x80	5x3	141.3x88.9 (5.56x3.50)	-	-	F	F	4.88 (10.80)
125x100	5-1/2 ODx4	139.7x114.3 (5.50x4.50)	C	E	F	D	4.88 (10.80)
	5x4	141.3x114.3 (5.56x4.50)	-	-	F	F	5.01 (11.04)
150x50	6-1/2 ODx2	165.1x60.3 (6.50x2.38)	-	-	D	D	6.29 (13.90)
	6x2	168.3x60.3 (6.63x2.38)	C	E	F	F	6.63 (14.60)
150x65	6-1/2 ODx3 OD	165.1x76.1 (6.50x3.00)	-	-	D	D	6.45 (14.20)
	6x2-1/2	168.3x73.0 (6.63x2.88)	-	-	F	F	6.26 (13.80)
	6x3 OD	168.3x76.1 (6.63x3.00)	C	E	D	D	6.30 (14.00)
150x80	6-1/2 ODx3	165.1x88.9 (6.50x3.50)	-	E	D	D	6.48 (14.30)
	6x3	168.3x88.9 (6.63x3.50)	C	E	F	F	6.83 (15.10)
150x100	6-1/2 ODx4	165.1x114.3 (6.50x4.50)	-	E	D	D	6.56 (14.50)
	6x4	168.3x114.3 (6.63x4.50)	C	E	F	F	6.90 (15.20)
150x125	6x5-1/2 OD	168.3x139.7 (6.63x5.50)	C	E	D	D	7.21 (15.90)

OD = Outside Diameter

Working pressure: **A** = max. 12.1 bar (175 psi) / **B** = max. 15.5 bar (225 psi) / **C** = max. 16 bar (232 psi) / **D** = max. 20.7 bar (300 psi) / **E** = max. 25 bar (363 psi) / **F** = max. 34.5 bar (500 psi) / - = no approvals

Nominal size		Pipe OD mm (Inch)	Approvals				Weight approx.
DN	Inch		VdS	LPCB	FM	UL	kg (lbs)
200x50	8x2	219.1x60.3 (8.63x2.38)	C	E	F	F	12.1 (26.6)
200x80	8x3	219.1x88.9 (8.63x3.50)	C	E	F	F	12.2 (26.9)
200x100	8x4	219.1x114.3 (8.63x4.50)	C	E	F	F	12.6 (27.7)
200x150	8x6-1/2 OD	219.1x165.1 (8.63x6.50)	-	-	D	D	12.4 (27.4)
	8x6	219.1x168.3 (8.63x6.63)	C	E	F	F	12.6 (27.7)
250x150	10x6	273.0x168.3 (10.75x6.63)	C	-	D	D	27.6 (60.9)
250x200	10x8	273.0x219.1 (10.75x8.63)	C	-	D	D	27.9 (61.5)
300x200	12x8	323.9x219.1 (12.75x8.63)	C	-	D	D	43.2 (95.2)

OD = Outside Diameter

Working pressure: **A** = max. 12.1 bar (175 psi) / **B** = max. 15.5 bar (225 psi) / **C** = max. 16 bar (232 psi) / **D** = max. 20.7 bar (300 psi) / **E** = max. 25 bar (363 psi) / **F** = max. 34.5 bar (500 psi) / - = no approvals

### Technical data

Type ..... 130R  
Material ..... ductile cast iron

#### Finish:

- Red paint ..... liquid painting similar RAL 3000
- Galvanized ..... hot dip galvanized

### Application

Water based fire-suppression systems

### Installation

Refer to "Grooved Products Installation Guide"

### Maintenance

Visual check

### Dimensional drawing

Dimensions in mm (inch)

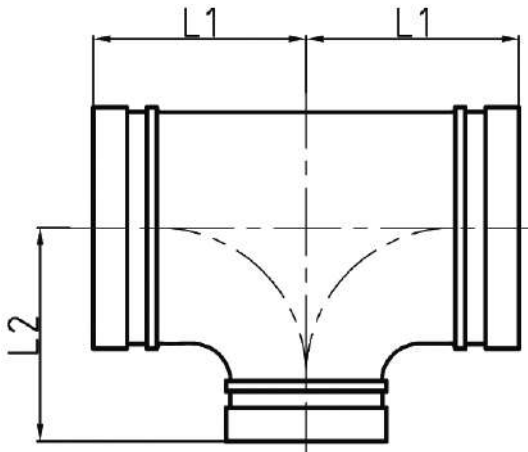

DN	Inch	L1 (mm / inch)	L2 (mm / inch)
50x40	2x1-1/2	70 (2.75)	70 (2.75)
65x...	3 ODx1-1/2	76 (3.00)	76 (3.00)
	2-1/2x2	69 (2.72)	69 (2.72)
	3 ODx2		
80x...	3x...	85.5 (3.37)	85.5 (3.37)
100x...	4x...	101 (3.98)	101 (3.98)
125x...	5x...	124 (4.88)	124 (4.88)
150x...	6x...	140 (5.50)	140 (5.50)
200x...	8x...	175 (6.89)	175 (6.89)
250x...	10x...	229 (9.00)	229 (9.00)
300x200	12x8	254 (10.00)	254 (10.00)